

HYDRON INCORPORATED



**ARBORIST
EQUIPMENT**

SADDLE ADD-ON'S

Add-On Back Saver Pad



This add-on tree saddle pad upgrades any saddle with a 3" wide back pad to a full 5 1/2" of cushioned back support. The add-on back saver is leather lined and filled with 1/4" thick foam to create a firm and comfortable back support. It easily attaches with four Velcro straps. Order small, medium, large, or x-large to match the size of your saddle.

1299

1299



Accessory Snaps

These add-on accessory snaps easily attach to the belt snap of our deluxe and lightweight climbing saddles. Also available with a 1 1/8" steel ring 342.

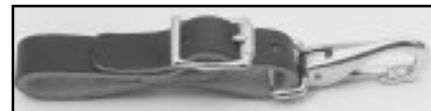

341



342

HIGH DENSITY ROLLER

The High Density Roller from Buckingham is designed to be used with the 1393 Versatile saddle or any other type of sliding dee ring saddle. It greatly reduces wear and tear on the suspension strap while providing the climber with easy and consistent side to side movement. Constructed of UHMW (Ultra High Molecular Weight) polyethylene, it is virtually indestructible. Works best if used with Model 5555WSA carabiner shown on page 29.



20 shown with 5555WSA (Carabiner not included).



20 shown on 1293 Versatile saddle.

THE BIG SHOT

The Big Shot is designed to launch a shot pouch (8 to 16 oz.) with a light line attached over a tree limb so a friction saver or climbing line can be pulled into place with little practice. A vertical distance of over 100' is easily achieved with great accuracy. The Big Shot head is designed to fit quick connect fiberglass poles to set up in seconds. The Big Shot is a must for every arborist. **Not For Use With Wooden Poles**

1027 Big Shot with two 4' Fiberglass Extension Poles



1027

For Throw Bags & Throw Lines see page 80.

**273 Weymouth Street, Rockland, MA 02370
Phone 781-871-1920 • Fax 781-878-1507 • www.hydrone.com**

HYDRON INCORPORATED

25Y12-46A

Tear Away Bungee Chainsaw Lanyard (Patented)

The Buckingham Tear Away Chainsaw Lanyard with the built-in bungee is designed for safety and convenience. It is constructed with a tear away safety pack that activates when 200 lbs. of force is applied. This feature eliminates the possibility of the user being pulled out of a tree if the saw gets hung up on a falling limb. It measures up to 50" fully extended to provide ample reach when cutting, but with the elastic bungee contracts to 32" when relaxed. This greatly reduces the possibility of getting tangled when climbing or working aloft. The saw, if dropped will fall below the user's feet without falling to the ground. To use, simply half hitch lanyard to the handle of the chainsaw, and attach to climbing saddle using a 1 1/8" steel ring, #2 bronze snap or 3/4" diameter loop. A 1 3/4" steel ring is used to suspend the chainsaw when not in use. Available in black or easy-to-see Hi-Vis Neon Yellow.

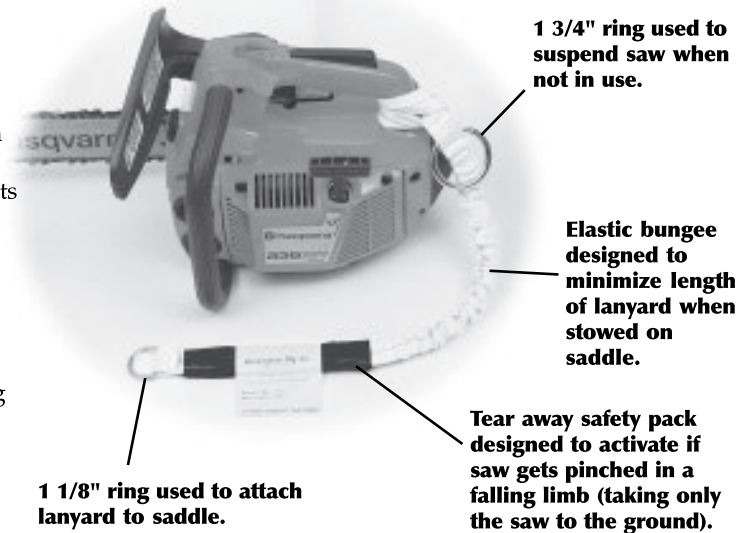

ARBORIST
EQUIPMENT

**NOT TO BE USED WITH
SAWS EXCEEDING
15 LBS. IN WEIGHT.**

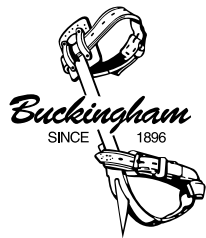

"Suspended on saddle."



"Fully stretched and ready to cut."



"Saddle attachment options."

No. Prefix	Chainsaw End	Saddle End	Total Length (Fully Stretched)	Options
25B = Black	1 = 6" Nylon Loop w/ twist half hitch to saw handle	2 = 1 1/8" Steel Ring	42"	A = 1 3/4" diameter steel ring to suspend saw when not in use
25Y = Hi-Vis Yellow		3 = #2 Bronze Boat Snap	44"	
		4 = 3/4" Diameter Loop	46"	
			48"	
			50"	

Accessory Straps

Accessory straps are very handy and have multiple uses. They are made with 1" nylon and are available in 12" and 18" lengths. They come standard with either a #2 bronze snap or 1 1/8" steel ring. Handy for stowing a chainsaw, or adding attachments on a saddle. Available in black, fluorescent green, orange and pink.

For 18" lengths add 18 to suffix (i.e. 60003-18G)

- 60002 12" Strap w/Ring black
- 60003 12" Strap w/Snap black
- 60002-G 12" Strap w/Ring green
- 60003-G 12" Strap w/Snap green
- 60002-O 12" Strap w/Ring orange
- 60003-O 12" Strap w/Snap orange
- 60002-P 12" Strap w/Ring pink
- 60003-P 12" Strap w/Snap pink



60002-G
60003-P

273 Weymouth Street, Rockland, MA 02370
Phone 781-871-1920 • Fax 781-878-1507 • www.hydrone.com